

## PAINTING GUIDE

To achieve a professional finish, make sure you use quality hobby paints and brushes. Take good care and clean them well after every time you use them and they will last a long time. Be sure to lay down some newspaper in the area you plan on working.

Use only plastic models made of ABS (opaque) and Polystyrene (clear) plastics, we recommend using :  
• Cement, MODELMASTER Liquid Cement For Plastic Models (#8872C),  
• Adhesive for gluing opaque parts together. For clear parts we recommend:  
• Cement or a standard White glue to avoid fogging of parts. Do not use any  
• other based glues as they do not work with ABS plastics. Always use extreme  
• care when using hobby tools.

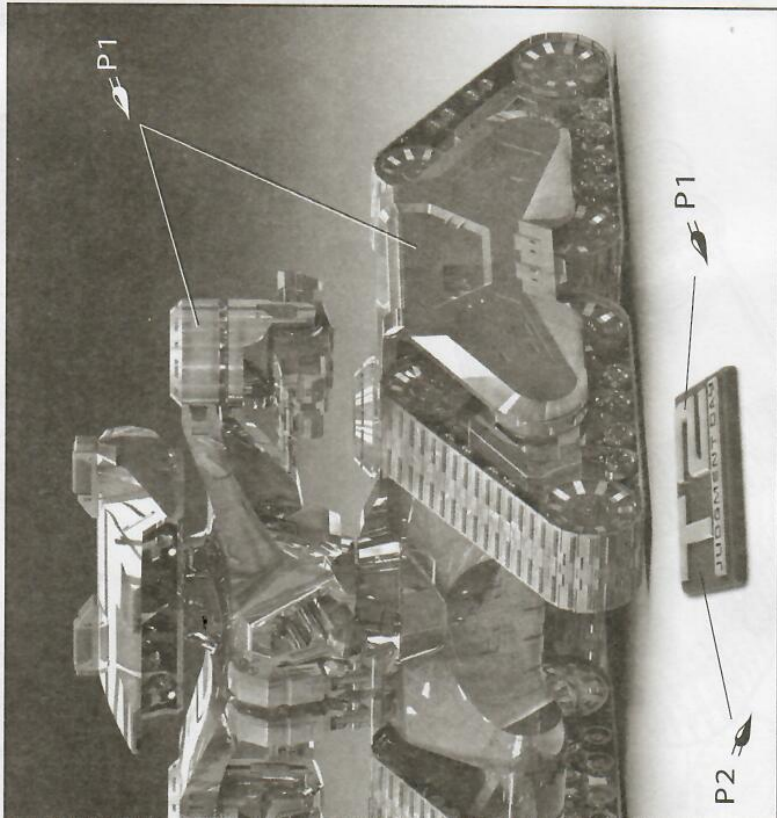

### Paint Color Chart

P1	Chrome Silver
P2	Flat Black

1/32 SCALE

## HUNTER KILLER TANK

PEGASUS  
HOBBIES



Straight from the iconic sci-fi masterpiece "T2: Judgement Day" comes the menacing Hunter Killer Tank model kit! With its striking futuristic design and lethal capability, it raised the bar for science fiction design and has been a long time fan favorite.

"The future is not set. There is no fate but what we make for ourselves" Machines have taken control of the planet. Humans have been targeted for termination. The future of mankind rests with the resistance fighters. Made up of Soldiers and the remaining human survivors, the resistance fights for mans survival.

## STUDIOCANAL

Terminator 2: Judgment Day, T2, THE TERMINATOR, ENDOSKELETON, and any depiction of Endoskeleton are trademarks of StudioCanal S.A. All Rights Reserved.  
©2014 StudioCanal S.A. All Rights Reserved.

2 Track "B" assembly (2X required)

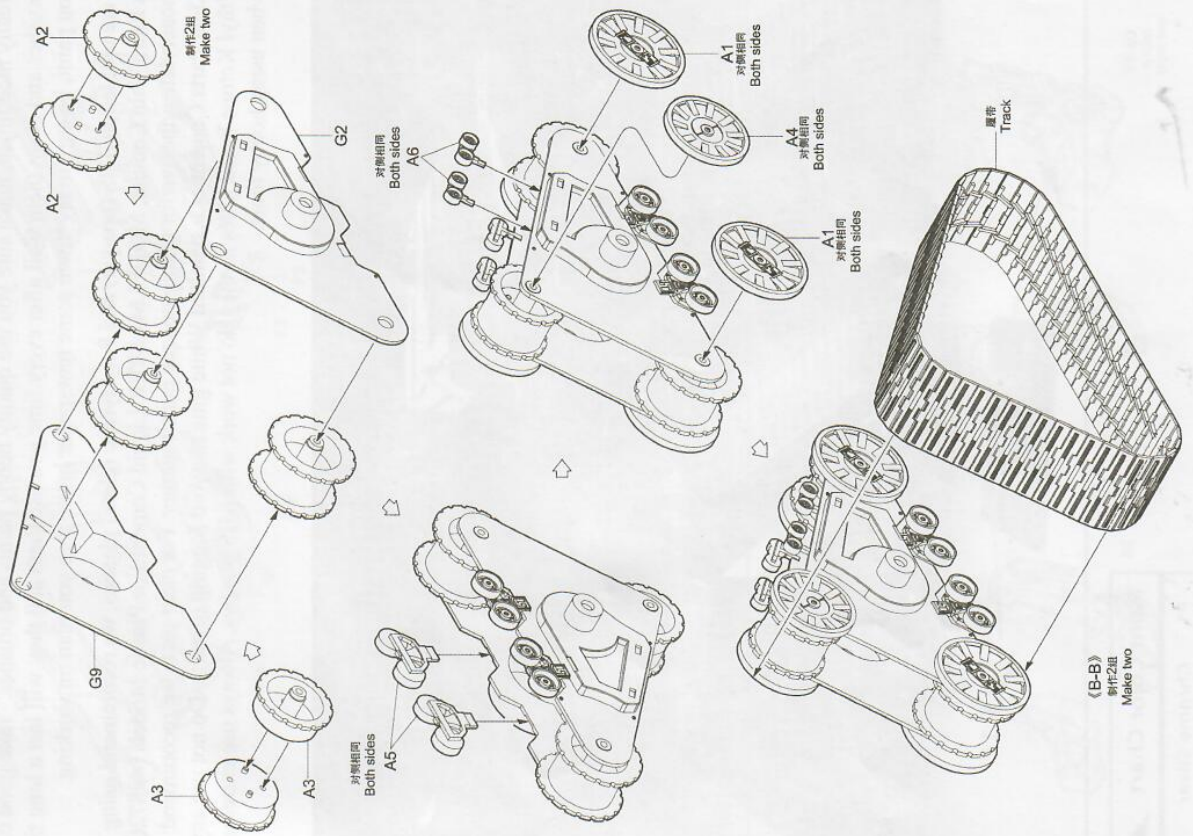

assembly (2X required)

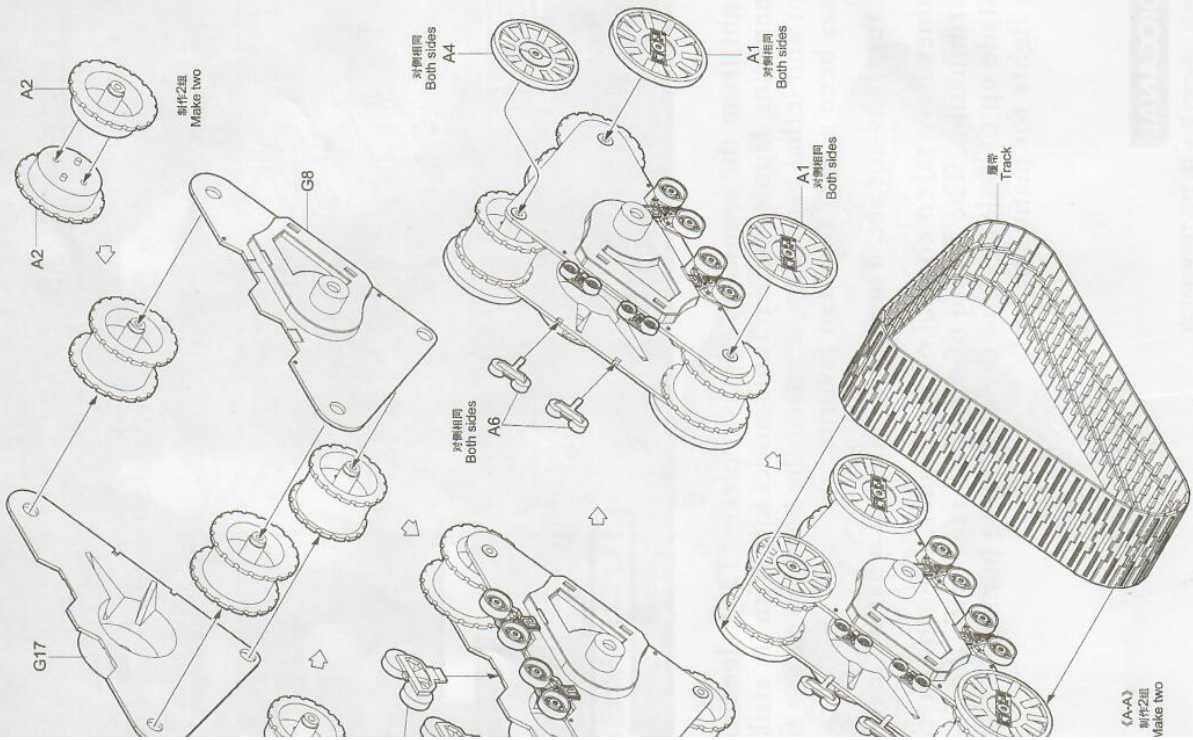

4 Hull assembly - Sides, Front & Rear

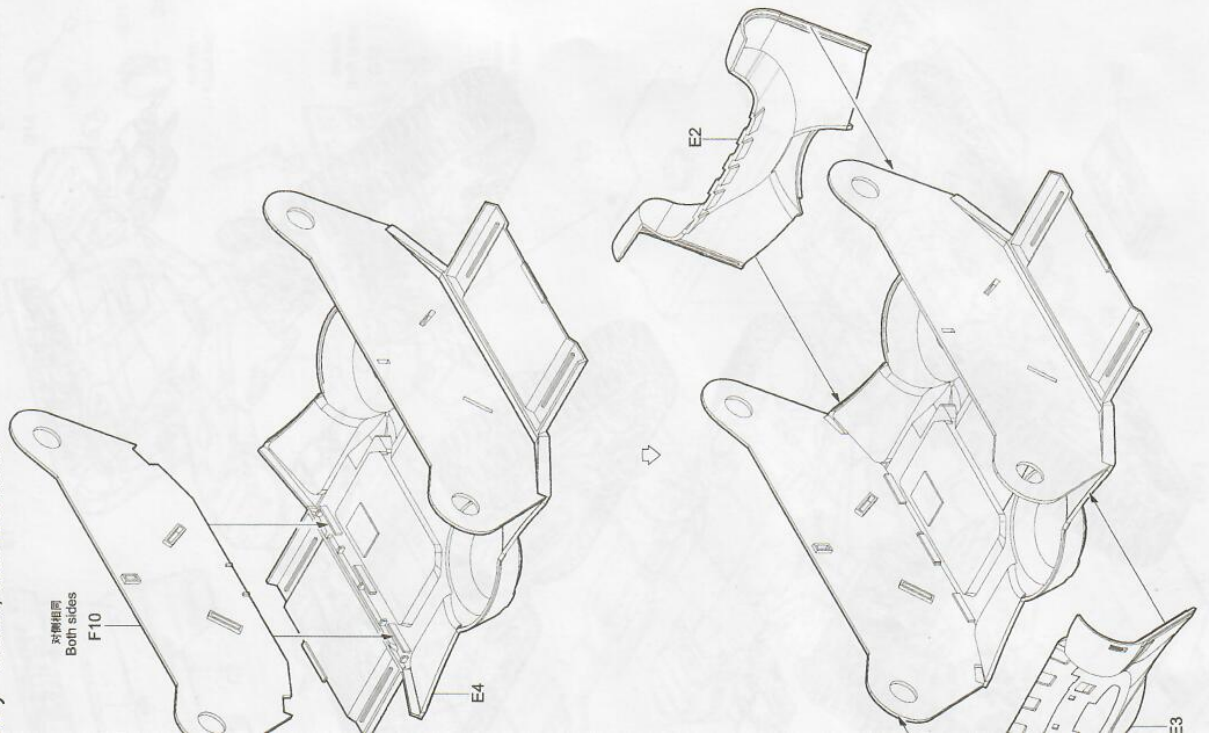

4 Hull assembly - Bottom

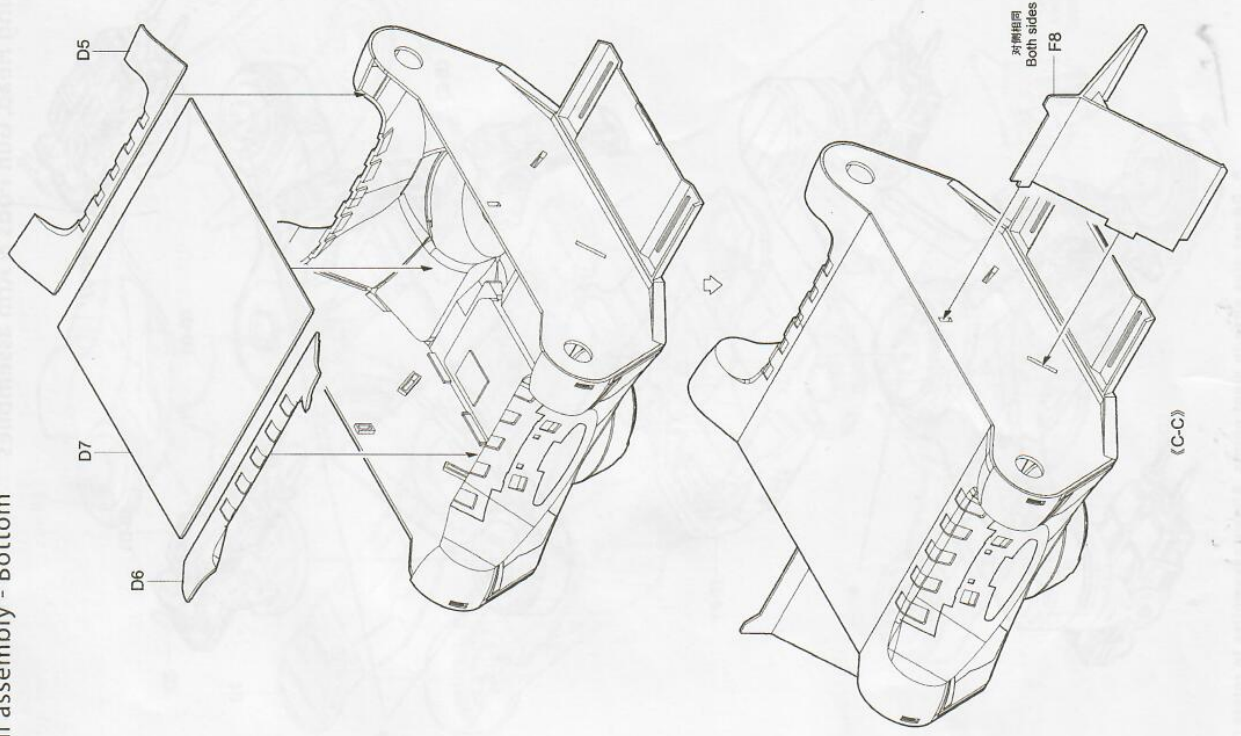

Track assemblies

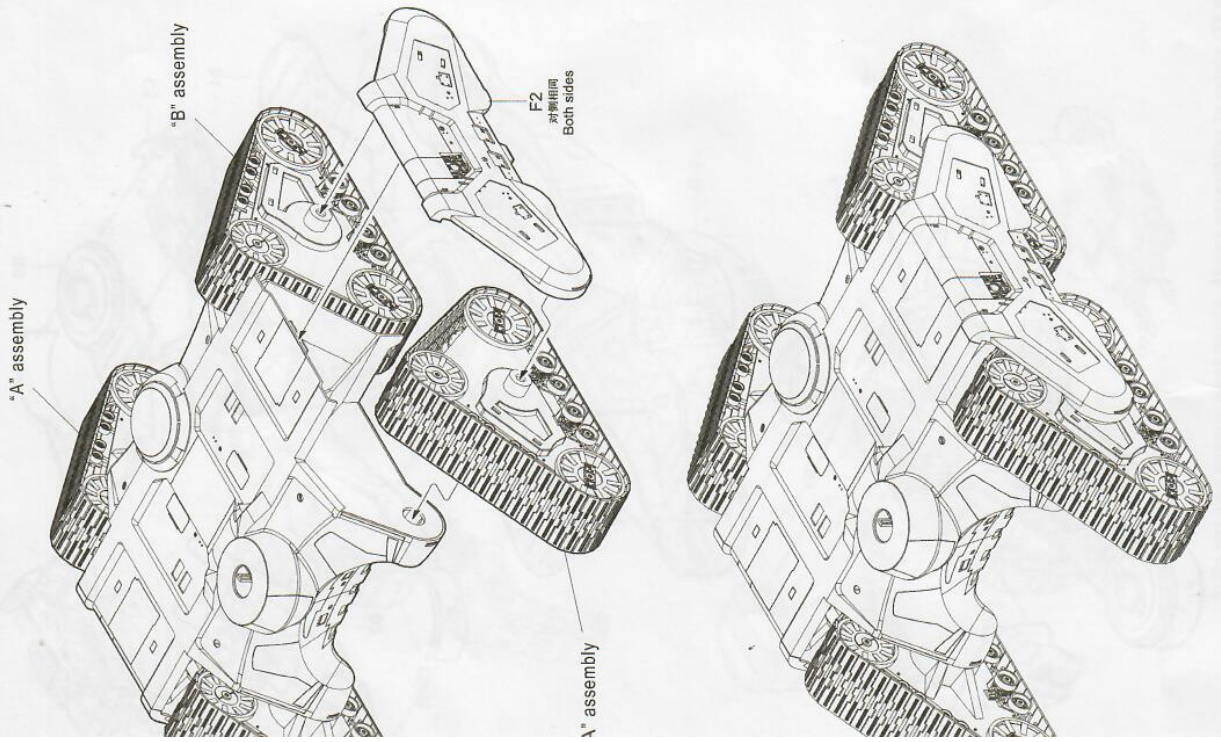

6 Gun Pod assembly (2X required)

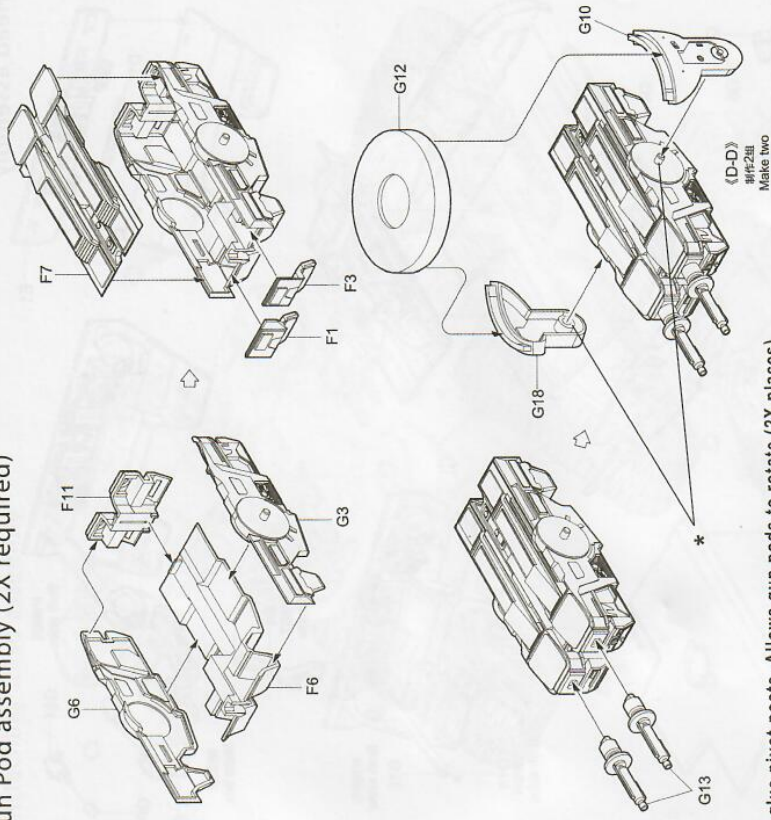

\* Do not glue pivot posts. Allows gun pods to rotate (2X places)

7 Front Arm assembly (2X required)

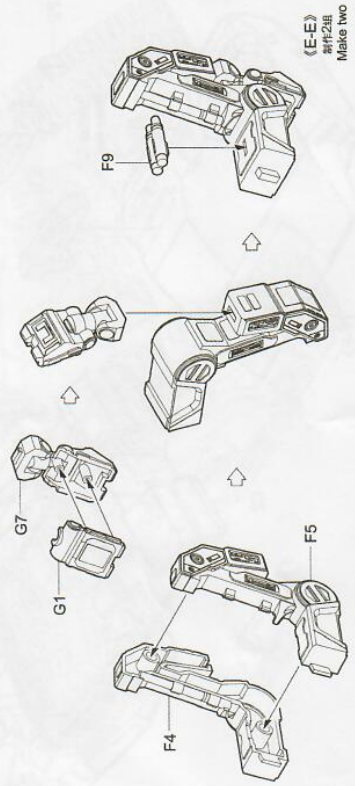

《E-E》 零件2組 Make two

# Torso assembly

9

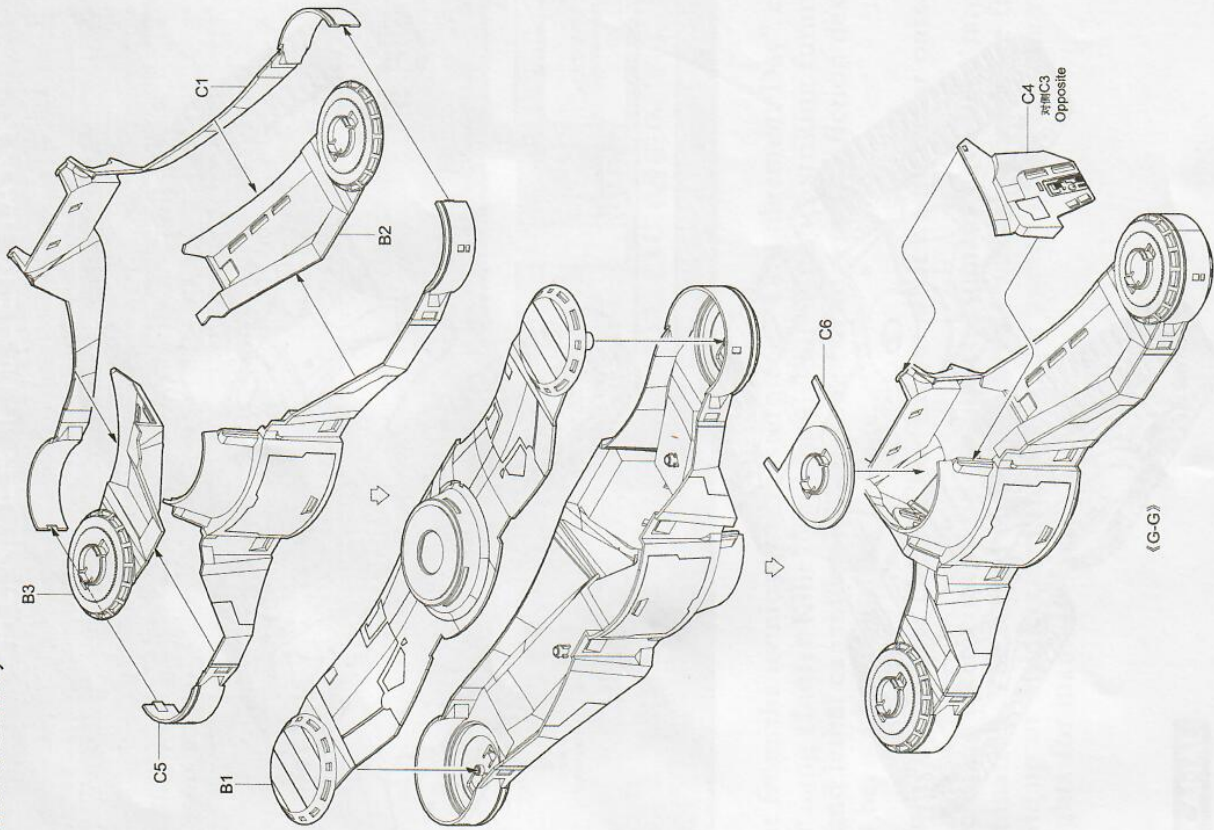

(G-G)

assembly

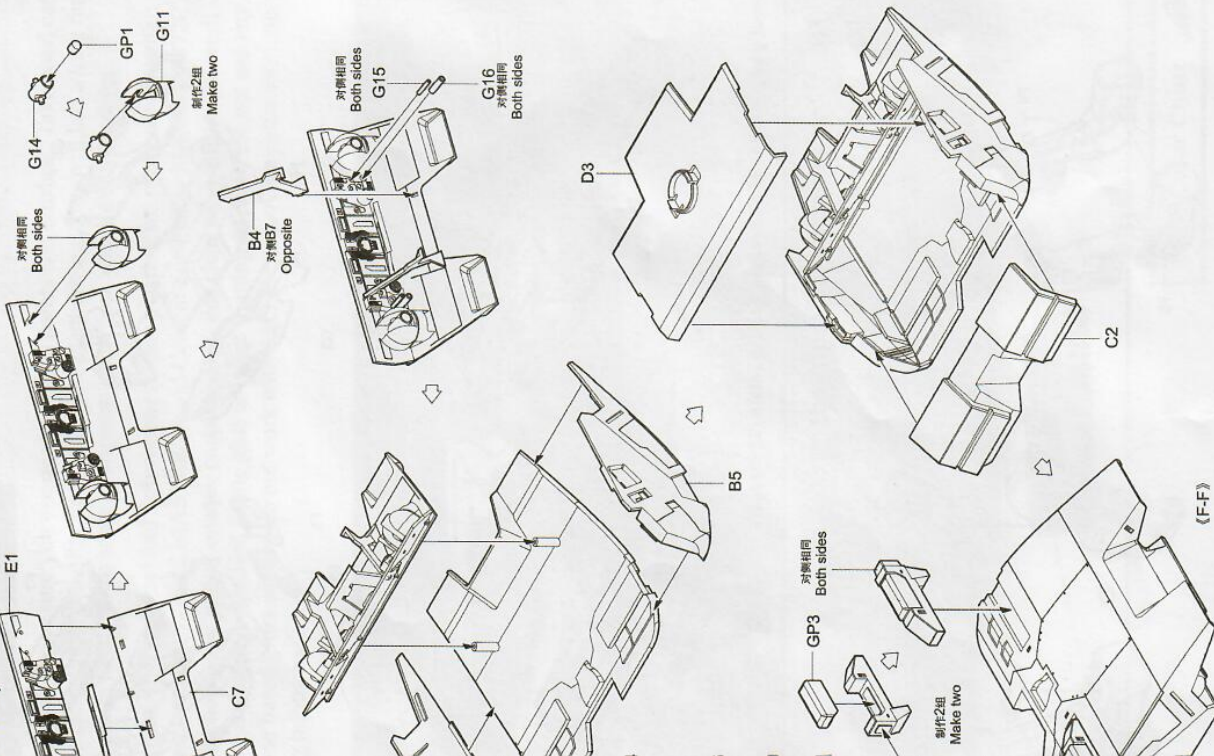

(F-F)

10 Head, Gun Pods & Arm assemblies

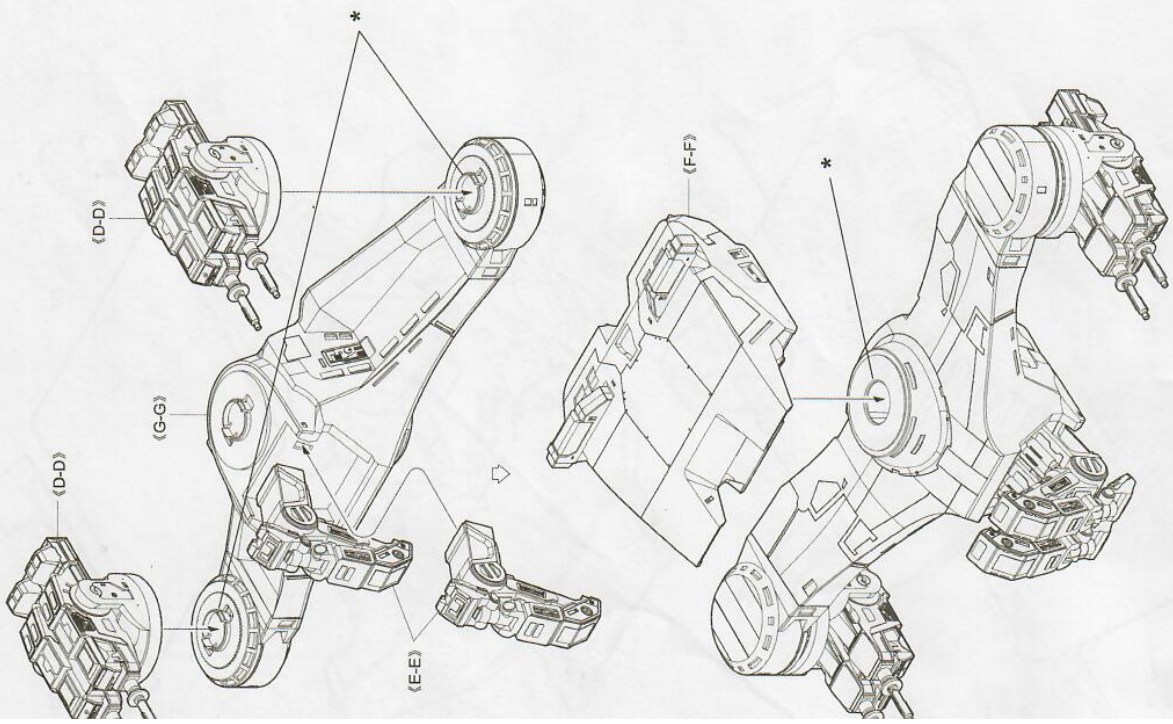

\* Do not glue snap-in pivot points. Allows assemblies to rotate (3X places)

11 Attaching Torso assembly

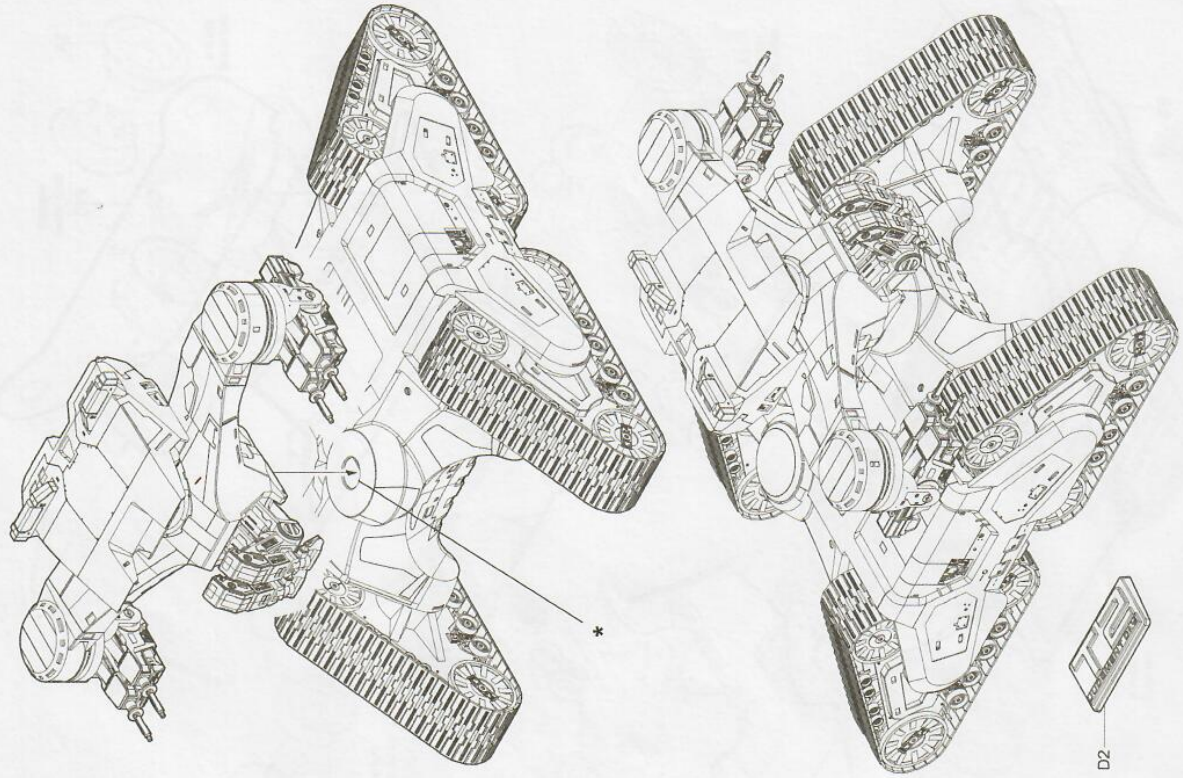

\* Do not glue snap-in pivot point. Allows Torso to rotate