



skill level 3 ages 15 and up • part no. 2001-1

# 2001: a space odyssey™



## the moon bus

lunar transport vehicle

### important - read this first

Before assembling the model, study pictures carefully. These instructions include detailed drawings and images of an actual build-up for reference. You can also refer to photos on the packaging. In addition, note the following:

- This model kit is molded of styrene plastic - use only styrene-compatible glues or cements.
- Apply cement to inside surfaces only; avoid getting cement on outer surfaces of model sections.
- Use cement sparingly and avoid getting cement on hands, so as not to mar or smear plastic surfaces.
- Do not hurry; work carefully and patiently.
- Before cementing, test fit parts dry (without cement) so that you may familiarize yourself with parts and fit, noting points where cement is to be applied.
- For best results assemble model in the order indicated.

### painting your kit

- Use paint that is made for use on plastic. If you are unsure, test paint on scrap pieces of the plastic sprue before applying it to kit parts.

- This model kit is designed to be built in sub-assemblies. It will be more convenient to paint each sub-assembly separately before final assembly of the kit.
- In certain cases it may be a good idea to paint some individual parts during assembly, before cementing.

### decals application

Decals have been provided to ensure the utmost detail and authenticity. Apply decals only after paint is completely dry.

- Dip the decal in water for 10 seconds. For best results, mix one drop of common dishwashing detergent per cup of lukewarm water.
- Place the wet decal face up on a paper towel and wait 30-60 seconds until decal is movable on paper backing.
- Wet the area of the model where decal will be applied.
- Hold the decal face up, in position on model and slide backing away from under it.
- Once positioned correctly, gently smooth out the decal and absorb excess water with a paper towel, cotton swab or clean, soft paintbrush.
- Let decals dry completely before applying any sort of dull coat or gloss coat to decal area, if desired.



## 1 fuselage

- a** Cement the **Floor Supports Front, Rear** (#44) and **Center** (#26) to slots in the **Fuselage Bottom** (#1). Cement the **Floor** (#2) to **Floor Supports**.
- b** Cement the **Starboard Side** (#4) to the right side of the **Fuselage Bottom Assembly**. Repeat for the **Port Side** (#5). Cement **Rear Door** (#23) to the **Fuselage Rear** (#10) and then cement the **Fuselage Rear** in place on the **Main Fuselage Assembly**.
- c** Cement **Rear Seats** (#55) to the **Floor**. Add **Pilot Seats** (#39) to the **Floor** at front.
- d** Cement the **Starboard Cargo Back** (#21) to the **Starboard Cargo** (#15). Cement **Starboard Cargo Assembly** to the **Floor**. Repeat procedure with **Port Cargo Back** (#22) and **Port Cargo** (#16).
- e** Cement **Motor Halves** (#27 & #28) together; cement the **Motor Assembly** to **Floor**.
- f** Cement **Center Console** (#24) to **Windshield Frame Platform** (#8). Cement the completed **Windshield Frame Assembly** to the **Windshield Frame** (#9).
- g** Cement the completed **Windshield Frame Assembly** to **Fuselage Bottom Assembly**.
- h** Cement six **Inner Rocket Halves** (#51) to six **Outer Rocket Halves** (#52). Cement three **Assembled Rockets** to each side of **Fuselage Bottom**.
- i** Choose the **Windshields** that you wish to use on your **Moon Bus**: **Vintage Port Windshield** (#63) and **Vintage Starboard Windshield** (#64) are the original-style parts as found in the classic vintage model kit (but do not match the shooting miniature). **Correct Port Windshield** (#66) and **Correct Starboard Windshield** (#65) parts provide the proper upright windshields that match the actual **Moon Bus** miniature.





## 2 walkers

- Cement six sets of **Outside Walker Halves** (#59 & #60) together. Cement three sets of **Center Walker Halves** (#61 & #62) together. Cement three sets of **Spring Halves** (#53 & #54) together.
- Cement a **Walker Platform** (#49) to the notches in two **Outside Walker Assemblies**. Cement a **Center Walker Assembly** to the locator pins on the bottom of the **Platform**. Cement the **Spring Assemblies** to the hole in top of the **Platform**. Cement two **Shock Assemblies** (#50) into the oval depressions on either side of the **Spring Assemblies** on the **Platform** top. Cement the **Upper Locator** (#48) between the two **Shock Assemblies**. Cement **Shock Absorbers** (#47) to each side of the **Upper Locator** and **Center Walker**. Repeat this procedure to assemble two more **Walkers**.
- Cement completed **Walkers** to bottom of **Lower Fuselage** as shown.

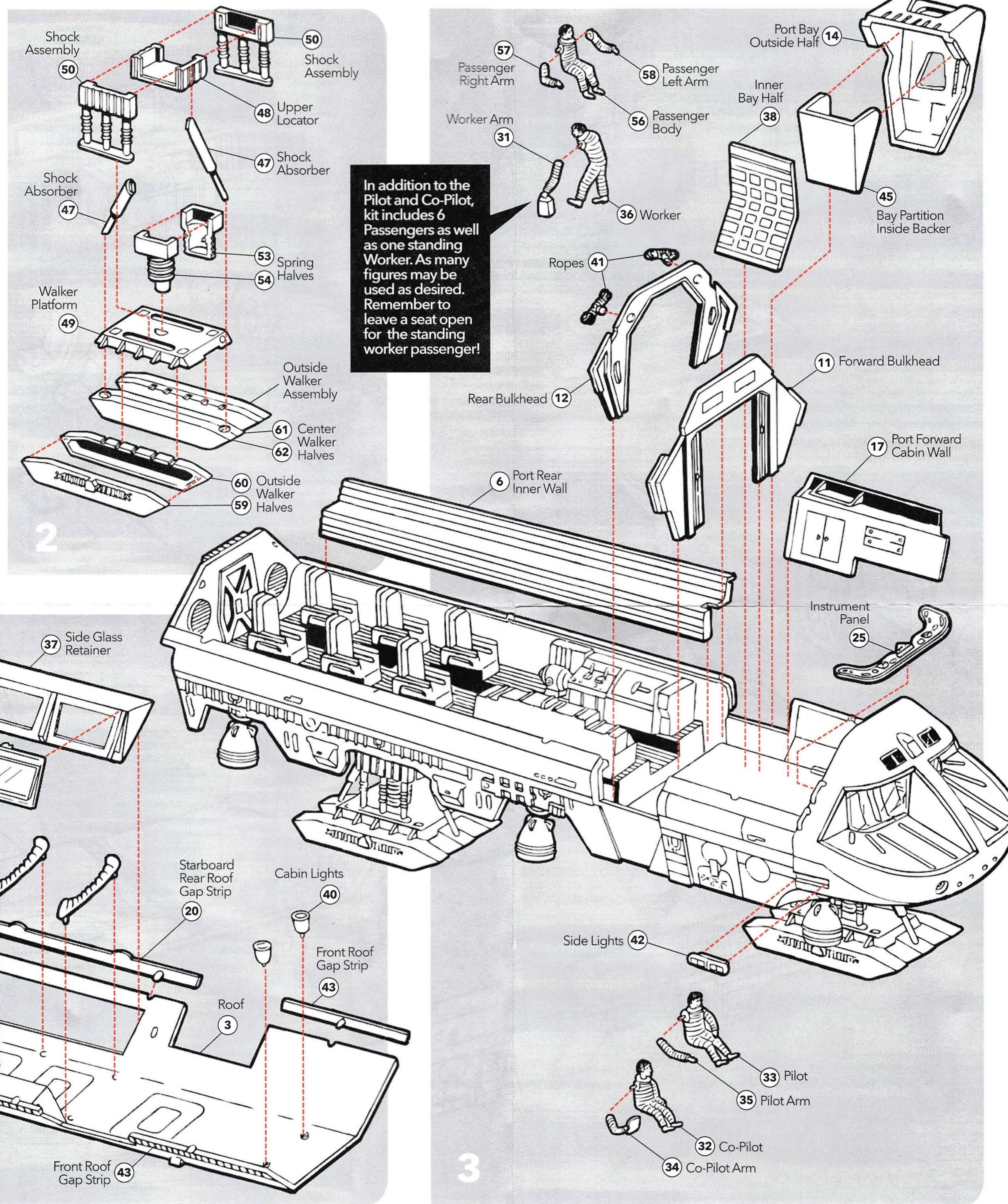

## 3 interior

- Cement **Port Rear Inner Wall** (#6) to **Floor** and **Port Fuselage Side**. Repeat for the **Starboard Inner Wall** (#7). Then cement **Forward Bulkhead** (#11) and **Rear Bulkhead** (#12) to **Floor** and **Fuselage Sides**.
- Cement **Ropes** (#41) to holes in **Rear Bulkhead**. Add **Side Lights** (#42) to each side of **Fuselage**. Cement **Port Forward Cabin Wall** (#17) to **Floor** and **Fuselage Side**. Repeat procedure with **Starboard Cabin Wall** (#18). Cement **Instrument Panel** (#25) to **Windshield Frame Platform** and **Forward Cabin Walls**.
- Cement **Bay Partition Inside Backer** (#45) into **Starboard Bay Outside Half** (#13); cement this **Starboard Bay Assembly** to the **Starboard Fuselage Side**. Repeat this procedure with **Bay Partition Inside Backer** (#45) and the **Port Bay Outside Half** (#14). Cement **Inner Bay Halves** (#38) to **Floor** between the **Front** and **Rear Bulkheads** on both sides of model.
- Cement **Co-Pilot Arm** (#34) to **Co-Pilot** (#32) and **Pilot Arm** (#35) to **Pilot** (#33); cement **Pilots** to **Pilot Seats**. Then cement **Worker Arm** (#31) to **Worker** (#36) and cement **Worker** to **Floor**. Cement **Passenger Arms** (#57 & #58) to the **Passenger Bodies** (#56). Cement the **Passengers** into **Seats**.

## 4 roof

- Cement **Cabin Lights** (#40) and six **Arches** (#46) to **Roof** (#3). Cement **Side Windows** (#67-1 & #67-2) into the two **Side Glass Retainers** (#37). Cement each **Side Glass Retainer** to the **Roof** as shown.
- Cement **Port Rear Roof Gap Strip** (#19) and **Starboard Rear Roof Gap Strip** (#20) to **Roof**; add **Front Roof Gap Strips** (#43).
- Cement the **Antenna** (#30) to **Antenna Base** (#29); cement **Antenna Assembly** to **Roof**. Set the **Roof** in place on the completed **Fuselage**. **Roof** may be cemented in place, if desired.



## ● paint & decals

The general paint colors described are suggestions only. Feel free to choose colors of your own liking or colors that you feel best represent the original shooting miniature as seen in the film.

Note that the build-up shown here sports a "clean" finish; the actual shooting miniature displayed some realistic weathering that the modeler may wish to recreate. The subtle raised and recessed details of the model provide the builder with many opportunities for simple paint effects, including airbrushing, washes and wipes.

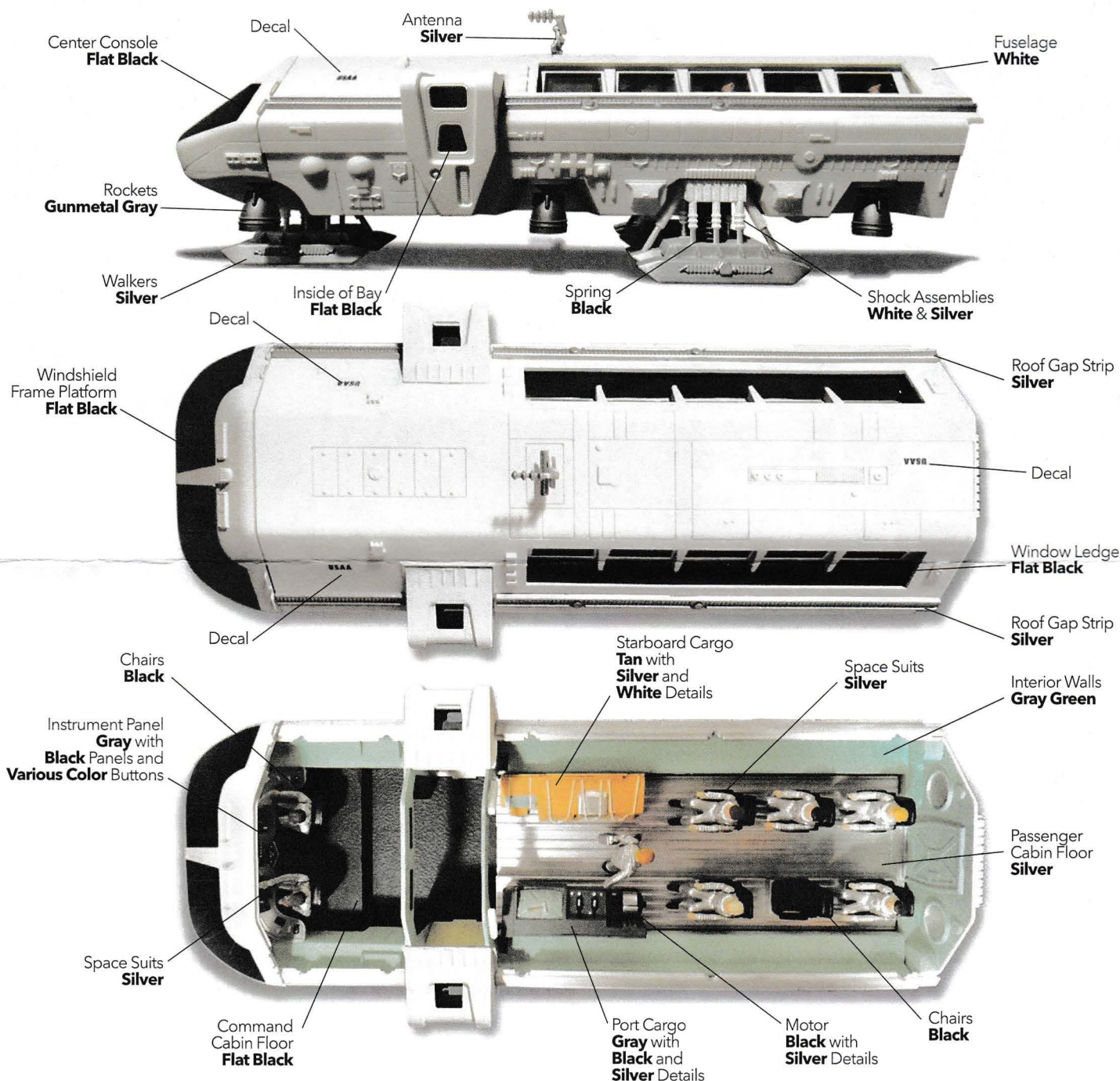

## ● lost or missing parts?

For lost or missing parts, please contact us at:  
[customerservice@moebiusmodels.com](mailto:customerservice@moebiusmodels.com)

Please include kit number and part number. Missing parts will be replaced at no charge, but a shipping and handling fee is required.

[moebiusmodels.com](http://moebiusmodels.com)

5515 Moreno St., Montclair, CA 91763



2001: A SPACE ODYSSEY and all related characters and elements © & ™ TEC. (s18)  
 Model shown was assembled and finished by a professional modeler.  
 Paint and cement required to complete kit – sold separately  
 © 2018 Moebius Models. All rights reserved. Made and printed in China.