

# X-WING COCKPIT

## For DeAgostini Kit ISSUES 63-64

**PARA  
GRAFIX™**  
PGX228

ParaGrafix states that our use of the trademarked terms listed below in our product descriptions constitutes fair use and nominative use and is in no way to offer confusion that ParaGrafix and any of the following noted trademark holders are related companies, nor do we state that we are endorsed by these trademark holders. We are an AFTERMARKET company acting in GOOD FAITH in providing high quality products to loyal customers who have already purchased products related to these trademarks. ParaGrafix is actually providing these trademark holders a venue of free advertising and indirectly provide these trademark holders with more sales leads.  
© & TM 2015 Lucasfilm LTD. © & TM DeAgostini Publishing USA Inc., DeAgostini Editore S.p.A.

## INTRODUCTION

Thank you for purchasing ParaGrafix's cockpit upgrade set for the Millennium Falcon subscription kit from DeAgostini Publishing. This set is intended for modelers of moderate experience who are handy at modifying existing kit parts.

Please note that these instructions replace most all of the kit's instructions for assembling the cockpit. It is suggested that you familiarize yourself with all aspects of the cockpit assembly before proceeding.

## Materials

In addition to the photoetch, you will also need scissors or a knife\* to remove individual pieces from the main fret, a file to remove material left from cutting, and super glue (aka CA or cyanoacrylate). Additionally, to fold some pieces, you will need a pair of razor blades\*\* or a specialty tool such as PhotoFold from ParaGrafix.

\* We prefer a #17 Xacto chisel blade in combination with a glass cutting board or other, similarly hard cutting surface.

\*\* Extreme care must be taken when using razor blades. Risk of serious injury.

## Raised Detail

Where applicable, these instructions note an area where the raised kit detail must be removed. This may be done in whatever way you are most comfortable: sanding, filing, chiseling. Note that in most cases the surface does not need to be perfectly smooth as the photoetched part will replace the "lost" kit detail.

## Lighting Options

Unless otherwise noted, you can prep areas for lighting by removing plastic from areas where there are through holes in the photoetch. You can then backlight the photoetch. For best results, we suggest using Micro Krystal Klear from Microscale Industries ([www.microscale.com](http://www.microscale.com)) to fill the through holes before applying the decals.

### TIP:

You can pierce the other holes to allow even more light through. In this case, once the holes are in place, refill them with Micro Krystal Klear or Testor's Clear Parts Adhesive and Window Maker. These materials may be painted from behind with transparent paint to add color.

## Installation Parts Order

The installation steps are not in any particular order. You can complete them as you see fit to complement your kit construction order.

## Decals

Please see our specific instructions for the use of the decals in conjunction with this set.

## Key

Kit part (plastic): **1**

Photoetched part: **1**

Decal: **A**

ParaGrafix Plastic: **1**

## Side Consoles

Cut out the top of each console as shown by the dashed, white lines, then attach the photoetch parts, paint, and apply the decals.

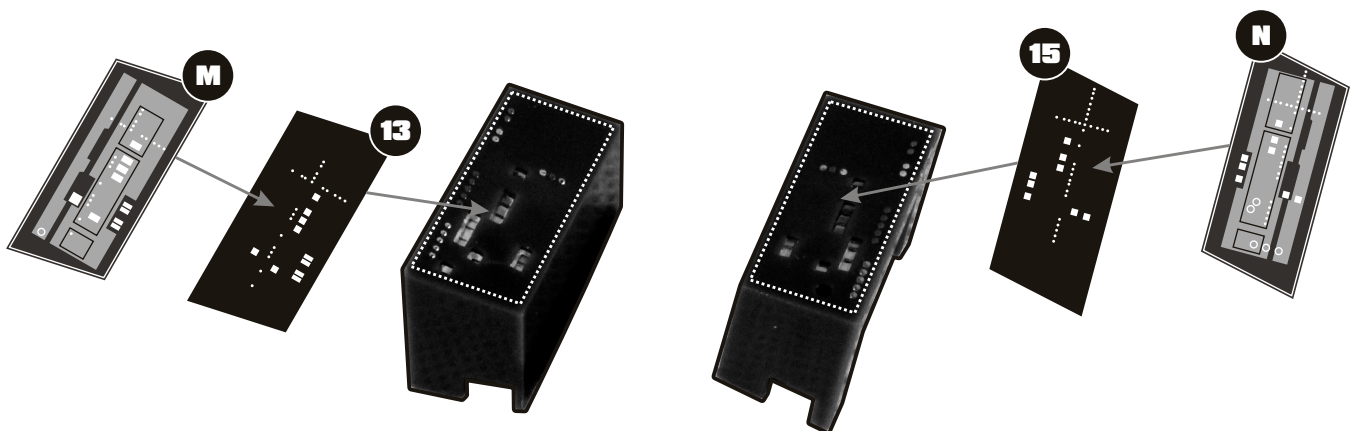

# Main Controls

Remove the areas outlined in the dashed, white lines to allow light through and plastic parts stuck through.

Apply all photoetched parts in the locations shown, then paint, and apply the decals. Once the decals are fully dried (allow up to 24 hours), pierce them through the holes in the photoetch to allow the tabs of the plastic parts through without tearing the decal. Insert the plastic parts as shown, and secure with super glue or epoxy cement. Continue with the plastic piping parts that came with the kit, following DeAgostini's instructions.

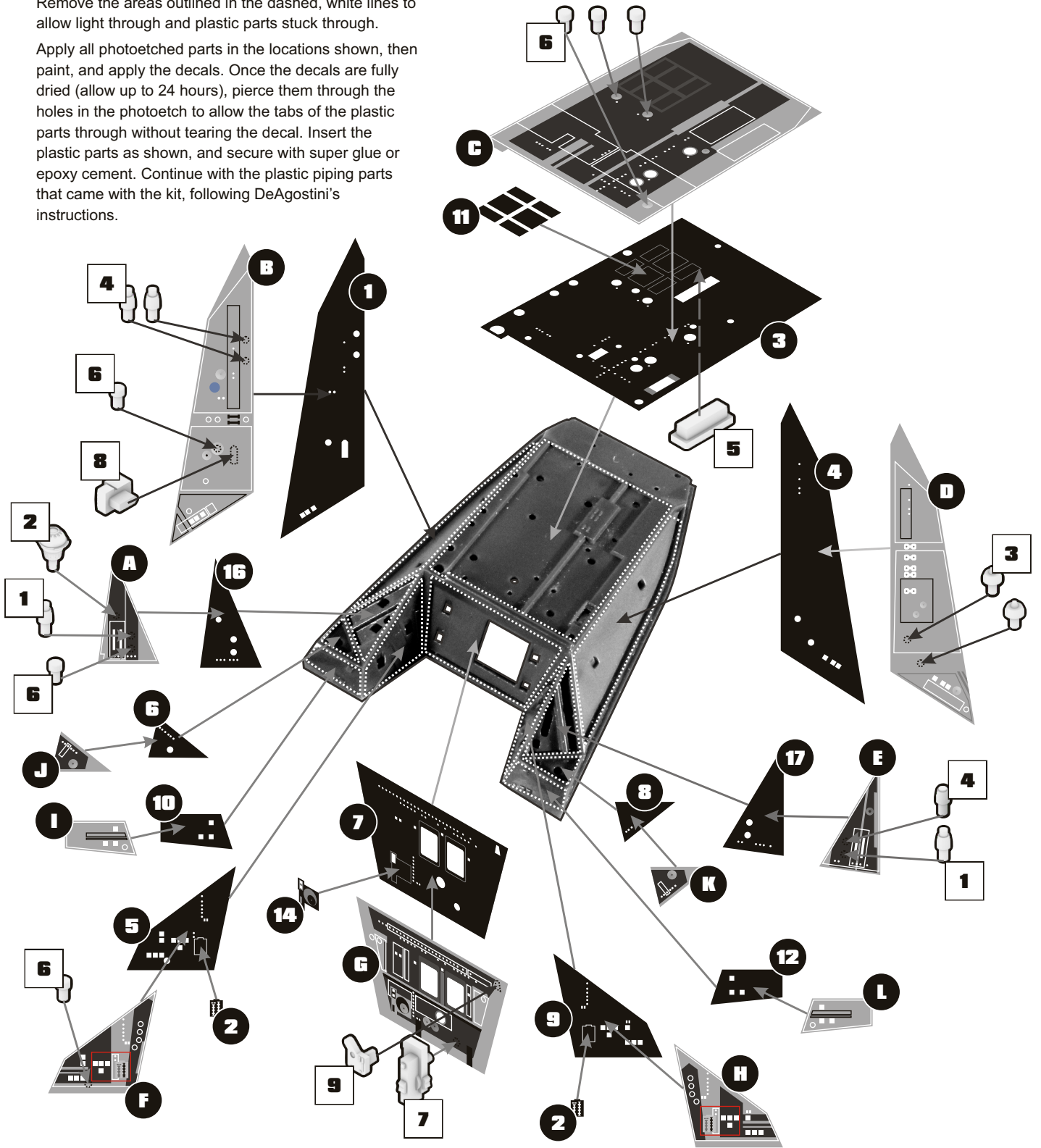

104 County Street, Suite 311  
Attleboro MA 02703 USA  
+1 508-431-9800  
www.ParaGrafix.biz