

BOBA FETT'S™ SLAVE I™

IMPORTANT! READ THIS FIRST

- Study assembly drawings carefully before starting.
- Each part is identified by a part number (14).
- Scrape paint from areas to be cemented.
- Before cement is used, check the fit of each part.
- Use only enough cement to join parts.
- Apply cement to small parts with a toothpick.
- Use cement made for styrene plastic only.
- Allow paint to dry thoroughly before handling.
- Your model may be painted to match the box photos.
- Cement all parts except where Do Not Cement symbol (⊗) is shown.
- Follow the step numbers (5) in each assembly drawing.
- ★ Refer to other assembly drawing for location.
- Refer to last page for decal and painting instructions.

- 5 — STEP NUMBERS
- 32 — PLASTIC PART NUMBERS
- (⊗) — OPTIONAL
- (⊗) — DO NOT CEMENT
- (⊗) — CEMENT HERE ONLY
- (2X) — REPEAT SEVERAL TIMES
- (⊗) — REMOVE
- ★ — REFER TO
- (⊗) — DECAL

© Lucasfilm Ltd. (LFL) 1982 TM: Trademark owned by Lucasfilm Ltd.(LFL) and used by Fundimensions Division of CPG Products Corp., under authorization.

1 (2X)

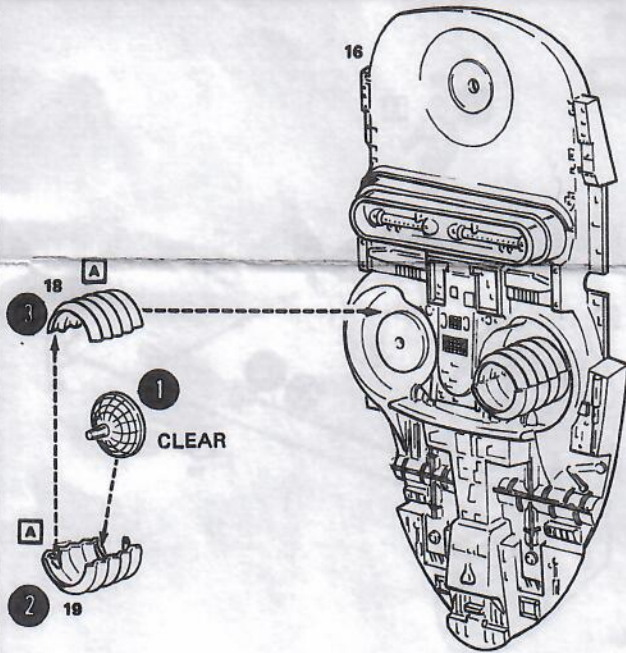

2

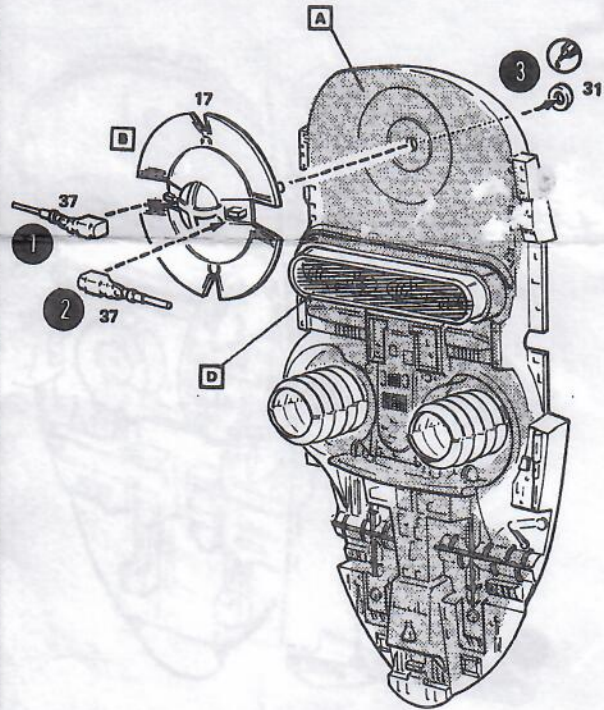

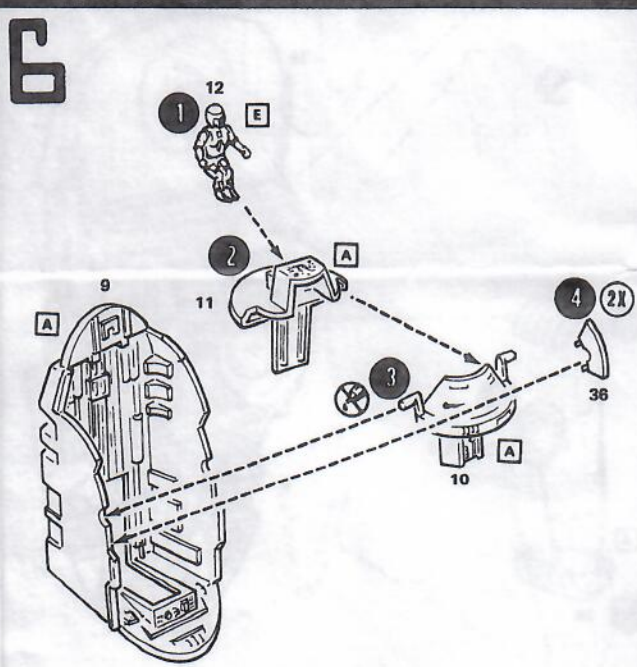
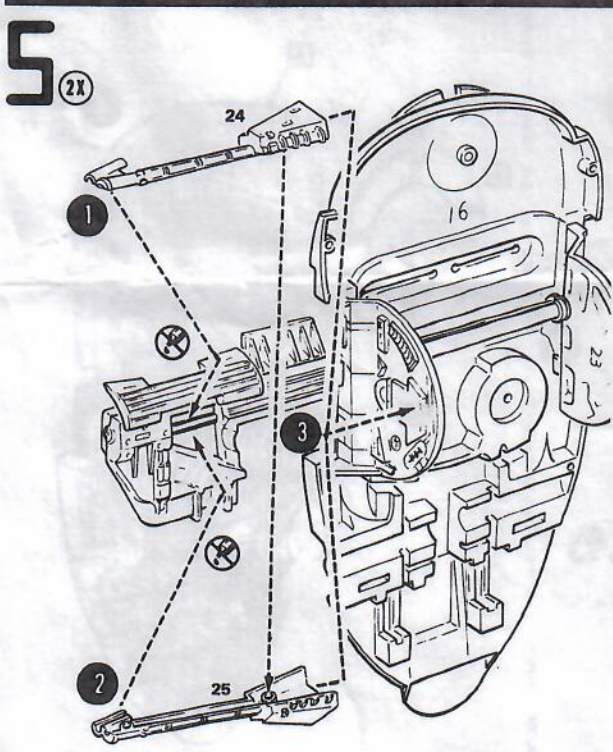
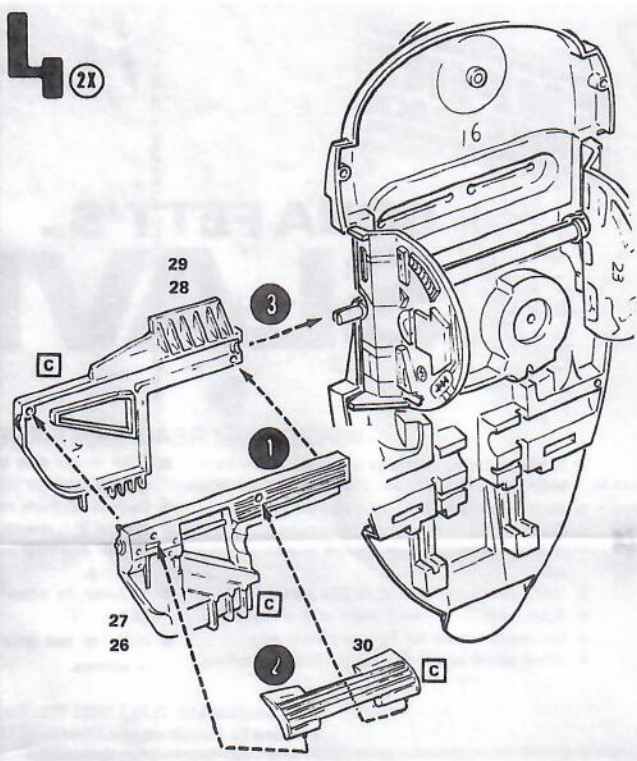
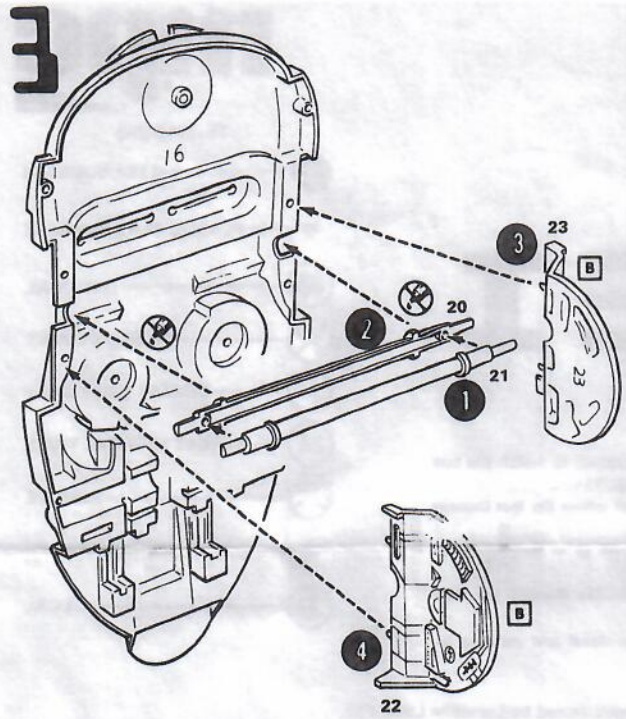

7

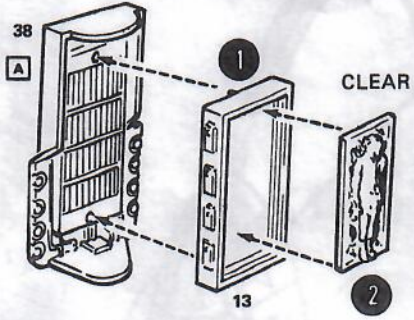

8

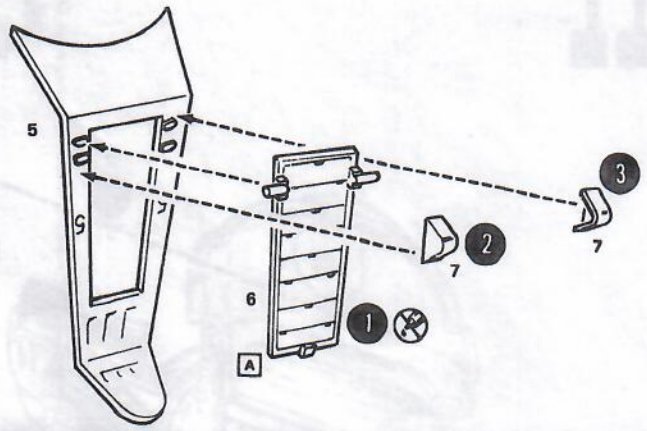

9

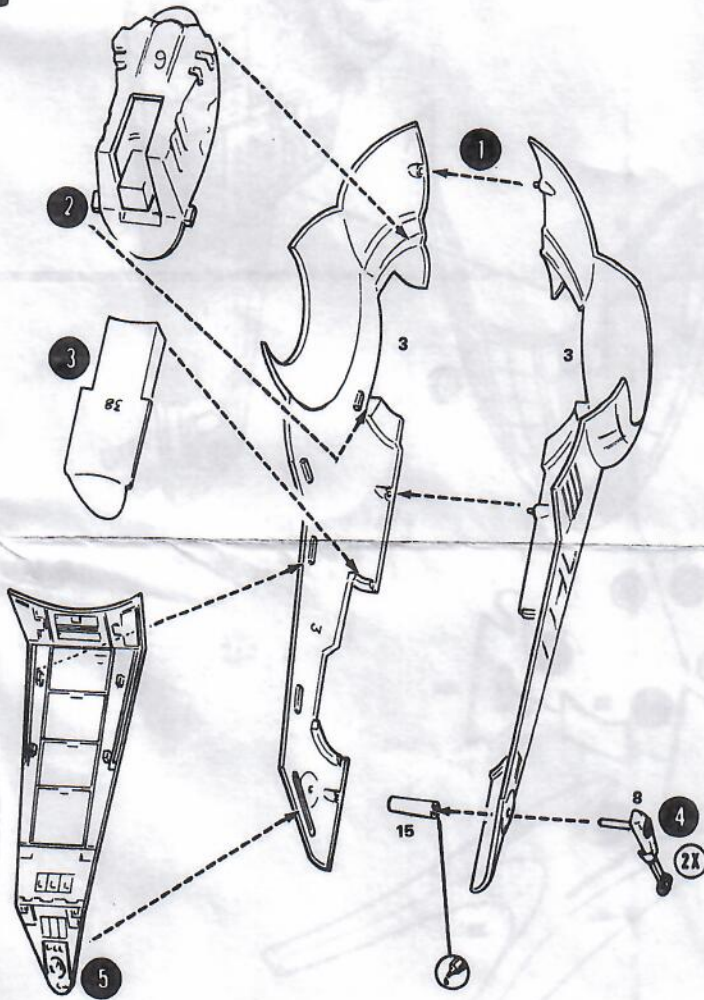

10

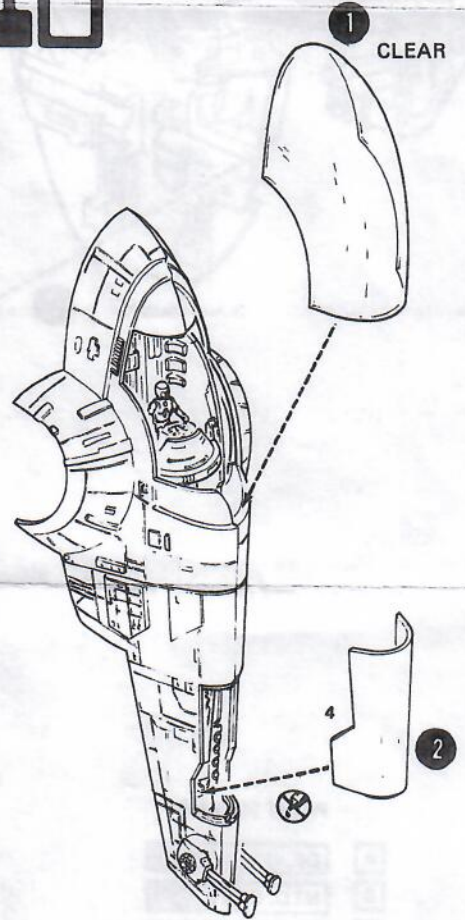

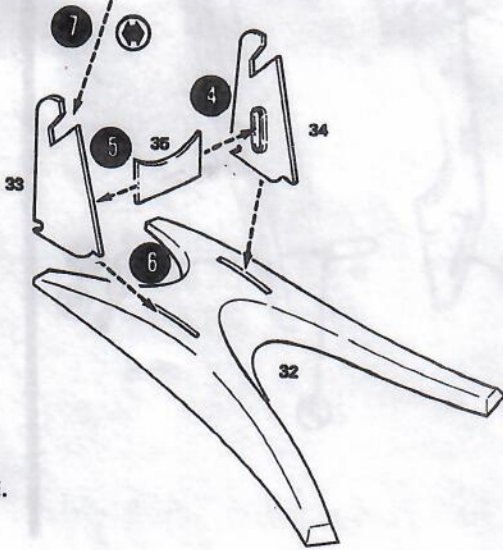
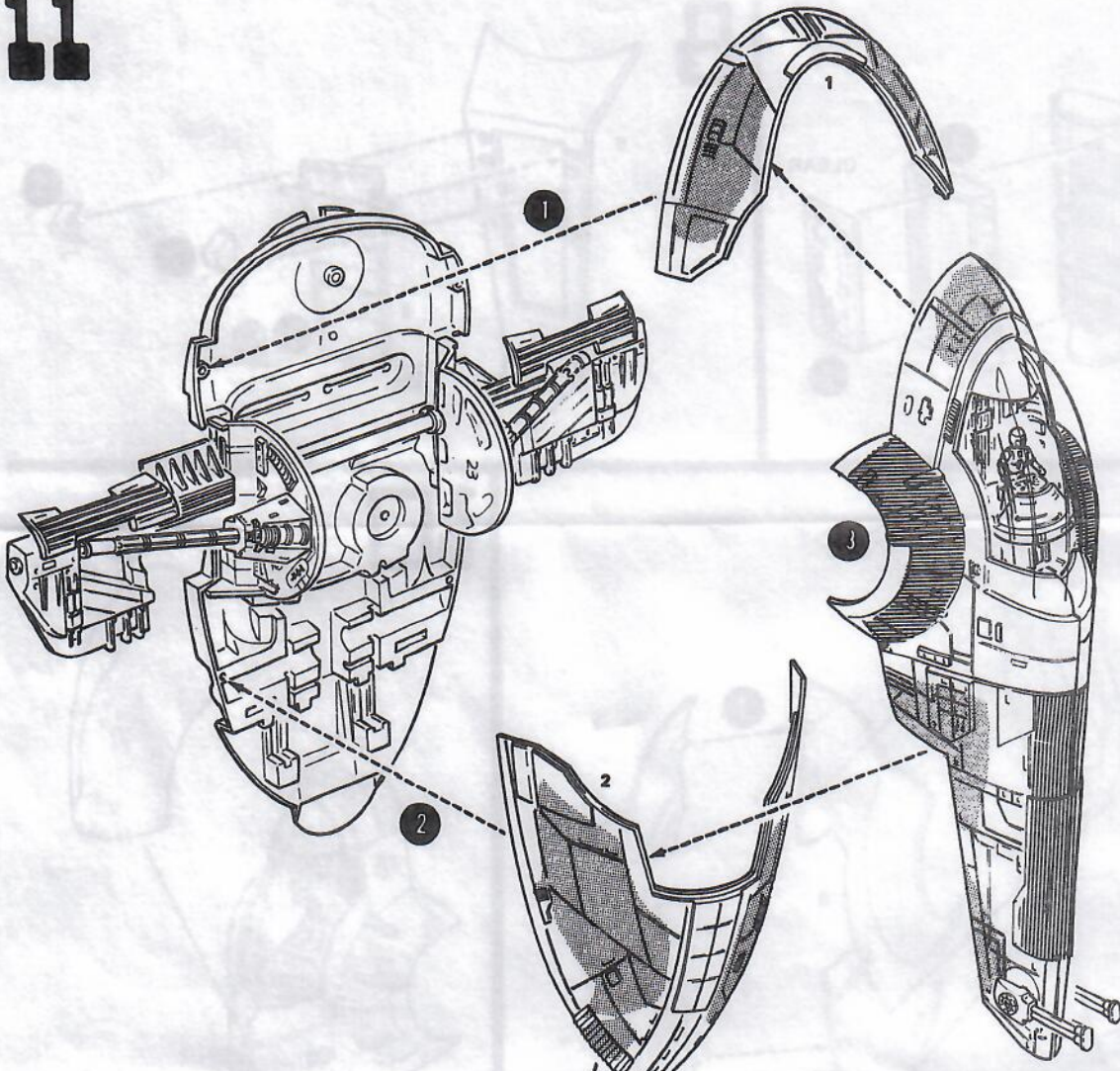

PAINT SCHEME

A	DK. GREY
B	MED. GREY
C	LT. GREY
D	RUST
E	SILVER

SEE BOX COVER FOR PAINTING REFERENCE.